

## PUT Timer

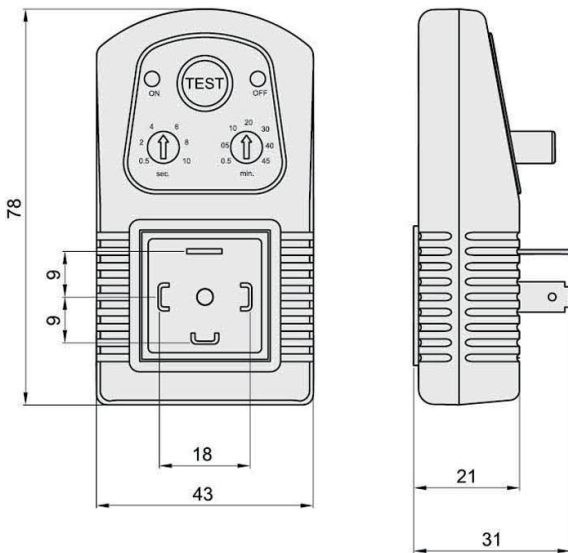

### Features

- Used to control Albion's range of solenoid valves.
- Range 0.5 to 10 seconds on, 30 seconds to 45 mins off.
- LED light to indicate timing

## Coils & Plugs

### COIL - SLPC



24, 110, 230VAC  
12, 24VDC

Orifice: 14.7  
L x W x H  
38.5x29x42mm

### COIL - SLP-HC



Type A  
24VDC  
110, 230VAC  
Type B  
12VDC  
24VAC

Orifice: 16.3  
L x W x H  
54x38.5x40mm

### COIL - ZSC-2D



Type A  
110, 230VAC

Orifice: Ø20.3  
63OD x 50mm

Type B  
24VAC, 12, 24VDC

Orifice: Ø20.3  
73OD x 50mm

### COIL - THP-C



24, 110, 230VAC  
24VDC

Orifice: Ø16.3  
50OD x 41mm

### PLUG - NAMUR SOLENOID

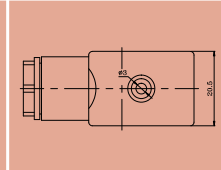
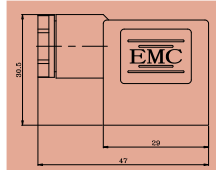

### PLUG - SLP/ZS RANGES

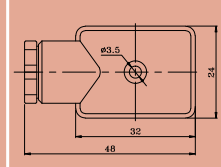
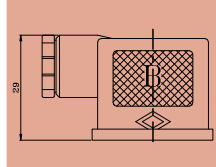

### PLUG - THP RANGE

